

**mahindra** Rainforest  
*HOME of POSITIVE ENERGY*



## THE NEW LANDMARK OF POSITIVE ENERGY

Unveiling Mahindra Rainforest — a mixed-use development that lets you leave the city's bustle behind while staying in the heart of it. With tripod towers framing panoramic greens, salt pans, and cityscape views, every home is designed to welcome light, air and positivity.



Spanning ~25.74 acres\*



7+ acres of landscaped green spaces\*



3.5 lakh+ sq.ft. of amenity spaces including clubhouses\*



65,000 sq.ft. of clubhouses\*



Tripod towers with panoramic views



Artistic impression for representation purpose only.

# THE GATEWAY OF POSITIVE URBAN LIVING

**Key Transit Routes**

LBS Marg	0 Km
Upcoming Bhandup Metro Line 4 Station*	0 Km
Bhandup Station	1 Km
Kanjurmarg Station	1.5 Km
Jogeshwari-Vikhroli Link Road	2.1 Km
Upcoming Goregaon-Mulund Link Road*	3.1 Km
Eastern Express Highway	3.7 Km
Chhatrapati Shivaji Maharaj	11.4 Km
International Airport	

**Schools**

St. Xavier's High School & Junior College	1 Km
Pawar Public School	1.2 Km
Poddar International School	4.8 Km

**Malls & Convenience Stores**

Neptune Magnet Mall	0.1 Km
Metro Wholesale	0.1 Km
Dmart	1.9 Km
Powai Plaza	3.9 Km
R City Mall	5.3 Km

**Colleges**

Guru Nanak College	0.8 Km
St. Xavier's High School & Jr College	1.6 Km
IIT Bombay	3.9 Km

**Hospitals**

Gaurav Maternity & Ortho Surgical Hospital	0.8 Km
Fortis Hospital	3.3 Km
Dr L H Hiranandani Hospital	4.5 Km

**Corporate Hubs**

Hiranandani Business Park	4.7 Km
Godrej IT Park	5.2 Km
SEEPZ	8.6 Km
BKC	16.2 Km

**Cinemas & Multiplexes**

Cinapolis Neptune Magnet Mall	0 Km
Inox, R City Mall	5.3 Km

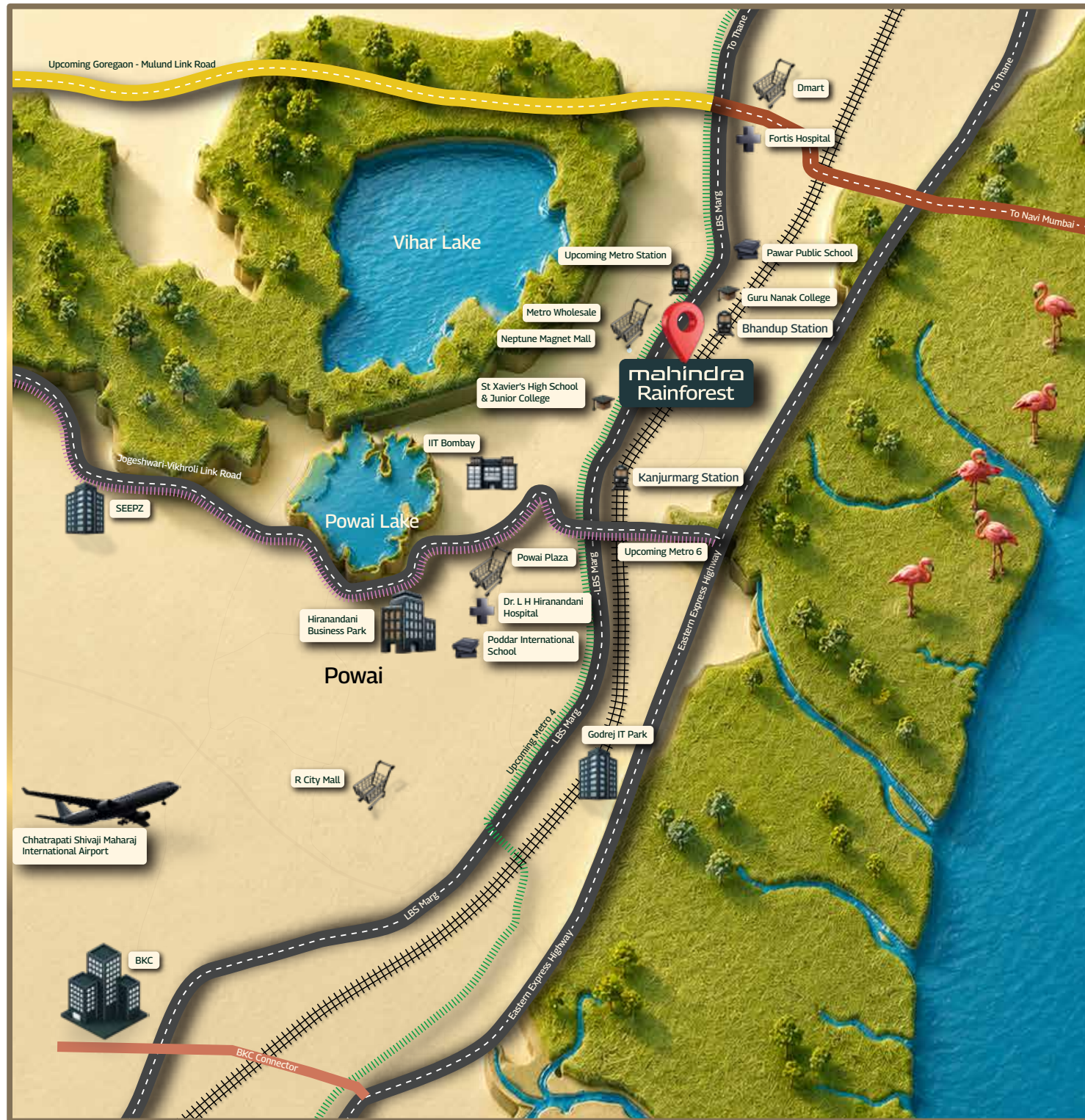

**POSITIVE ENERGY IS  
ALWAYS BUZZING**



Olympic-length swimming pool

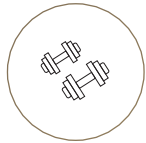

State-of-the-art gymnasium

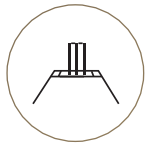

Cricket ground\*



Indoor games room



Two badminton courts

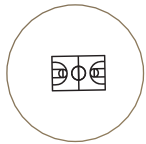

Multipurpose sports court



Outdoor fitness area



Indoor kids' play area

and more

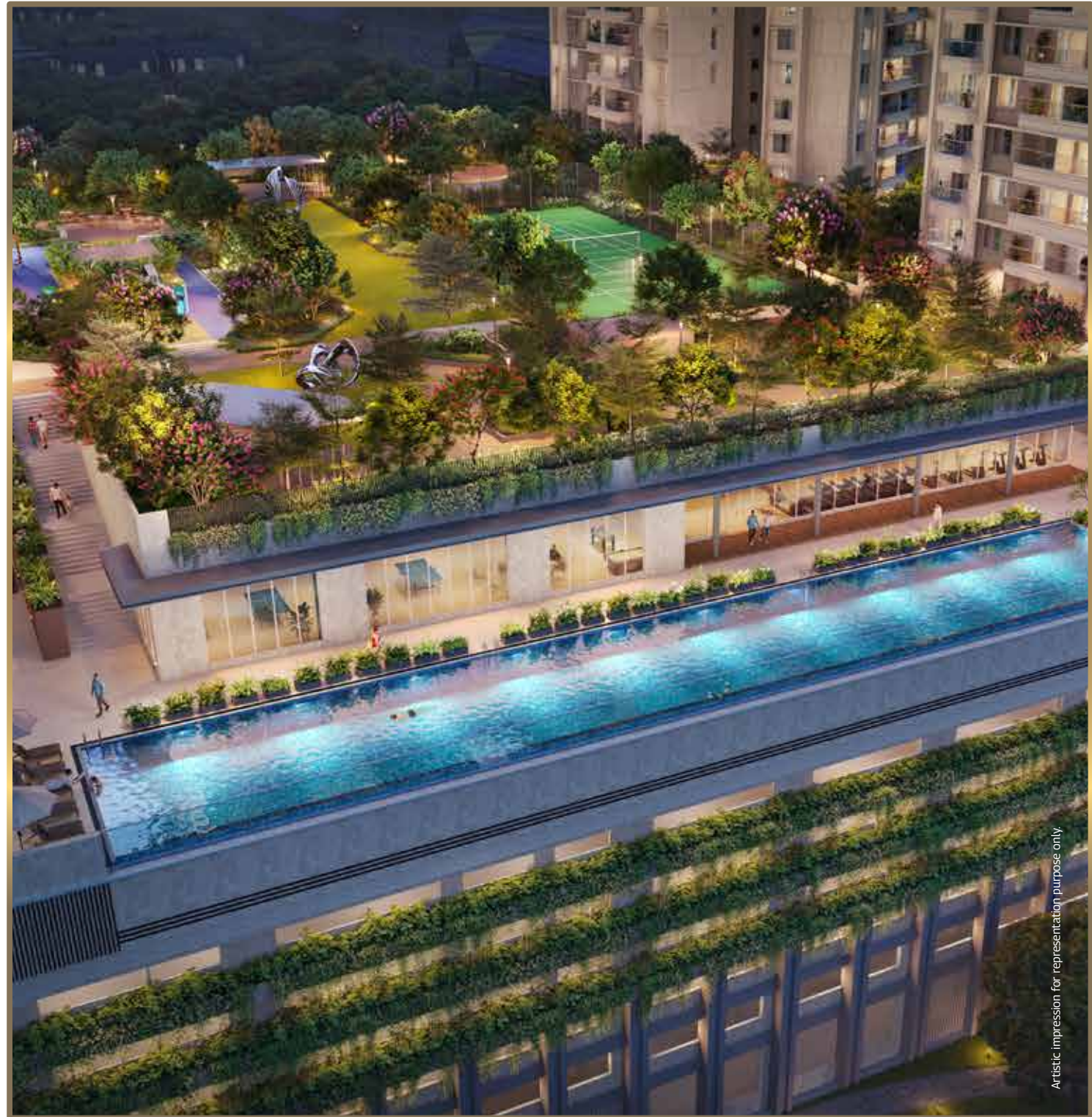

Artistic impression for representation purpose only.

# MASTER PLAN

## Phase 1 & 2

### Open Area Amenities

1. Swimming pool with deck
2. Multipurpose sports court
3. Outdoor kids' play area
4. Event lawn
5. Outdoor fitness area
6. Net cricket

### Clubhouse 1

- Two badminton courts
- Gymnasium
- Indoor games room
- Aerobic / yoga area
- Indoor kids' play area
- Reception area





AI generated image for representation purposes only

**7+ acres of landscaped green spaces\***

\*Disclaimer: The details are available on <http://maharera.maharashtra.gov.in>. Proposed common amenities shall be for use by all phases. Please refer to the agreement for sale for detailed terms and conditions.

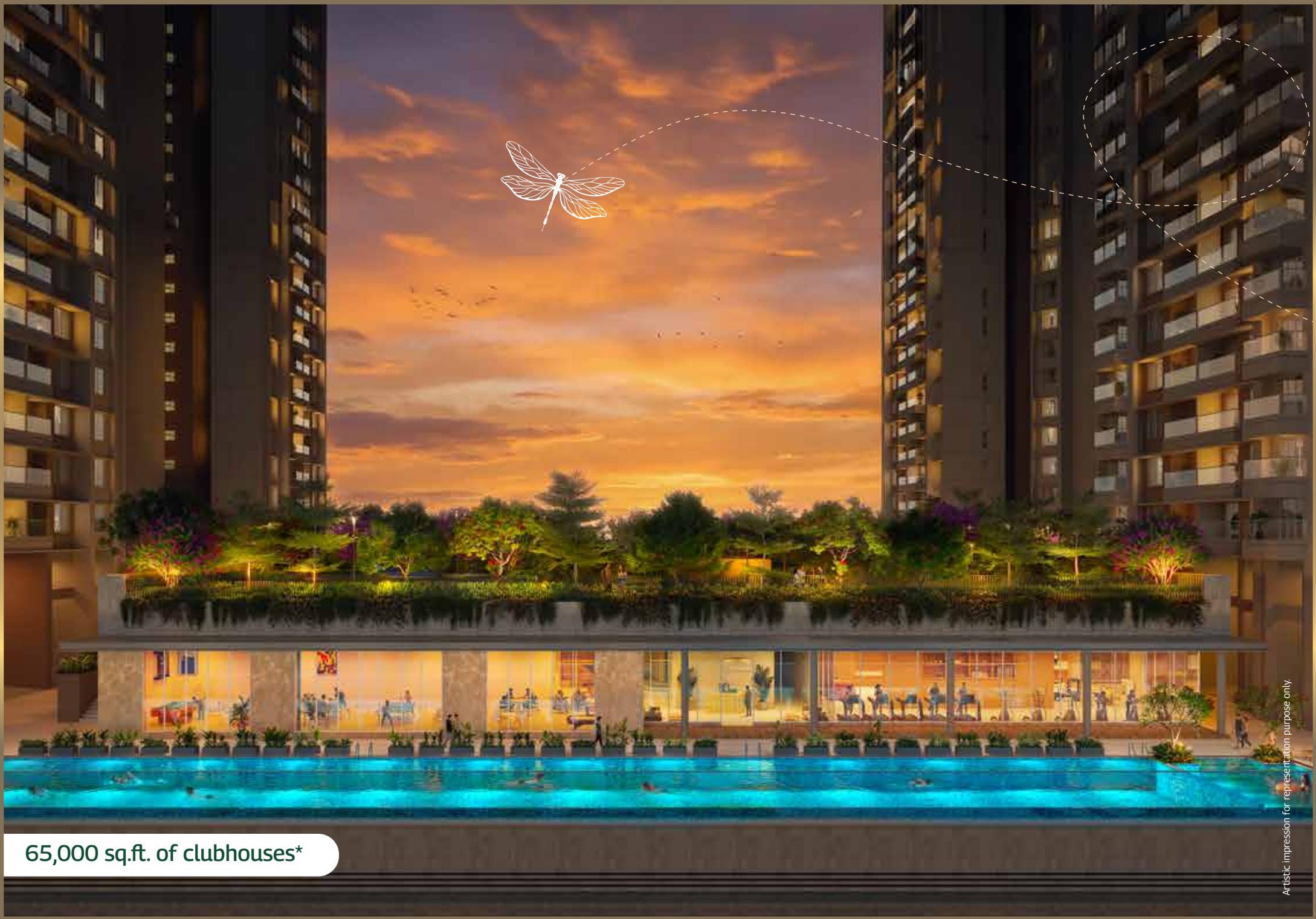

65,000 sq.ft. of clubhouses\*

Artistic impression for representation purpose only.

\*Disclaimer: The details are available on <http://maharera.maharashtra.gov.in>. Proposed common amenities shall be for use by all phases. Please refer to the agreement for sale for detailed terms and conditions.



Artistic impression for representation purpose only

Olympic length swimming pool



Drop-off



Clubhouse lobby



Indoor games room

Artistic impressions for representation purposes only



Gymnasium



Two badminton courts



Yoga room



Indoor games room



Drop-off

# DRIVING NET ZERO WITH POSITIVITY



## Energy

- ▶ 66% saving in common area lighting bill. Demand met through on-site renewable sources



## Water

- ▶ 42% water saved through efficient fixtures, rainwater harvesting and STP



## Carbon emission

- ▶ 7400 T of CO2 emissions saved annually, equivalent to saving 2.9 lakh fully grown trees



## Waste

- ▶ 7,00,000 kg of waste diverted from landfill equivalent to 700 trucks
- ▶ 100% organic waste converter to fulfil manure requirement of the landscape



## HOMES FILLED WITH POSITIVE ENERGY



Corner units open on more than two sides



Foyers for optimum privacy and storage space



Kitchens designed with parallel platform and utility

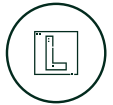

L-shaped living & dining room\*



Customizable half-bedroom\*



Master bedroom with walk-in wardrobe and balcony\*



Two decks to enhance living experience\*



\*In select units only.



# **mahindra** Rainforest

*HOME of POSITIVE ENERGY*

 **Project address: LBS Marg, Kanjur**

 **[mahindralifespaces.com](http://mahindralifespaces.com)**

Contact your relationship manager for more details



Disclaimer: "Mahindra Rainforest" is a project being developed by Anthurium Developers Limited and GKW Limited in a phase-wise manner. "Mahindra Rainforest Phase 1" bearing Registration no. PM1181012502957. "Mahindra Rainforest Phase 2" bearing Registration no. PR1181012502956. The details are available on <http://maharera.maharashtra.gov.in>. Proposed common amenities shall be for use by all phases. Please refer to the agreement for sale for detailed terms and conditions.

